

# Applegate Park

Kingsbridge

TOTNES  
E 3





SINCE 1992

## TOTNES

### 3 FH

A three bedroom home with open plan living to the lower ground floor, where French doors open onto the rear garden. A family bathroom and two double bedrooms are on the ground floor, including en-suite and fitted wardrobe to the master. The third double bedroom occupies the first floor, complete with en-suite.

#### LOWER GROUND FLOOR

Kitchen/Living/Dining 3.12 – 5.11m x  
4.02 – 8.74m

#### GROUND FLOOR

Bedroom 1 5.09m x 3.02m  
(inc wardrobe space)  
En-suite 1.32m x 2.16m  
Bedroom 3 3.10m x 3.40m  
Bathroom 1.70m x 2.16m

#### FIRST FLOOR

Bedroom 2 3.09m x 4.32m  
(exc dormers)  
En-suite 1.91m x 2.15m

\* Window to selected plots.

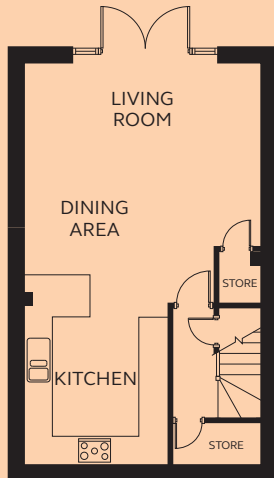

LOWER GROUND FLOOR

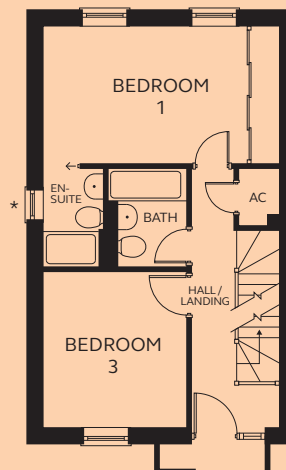

GROUND FLOOR

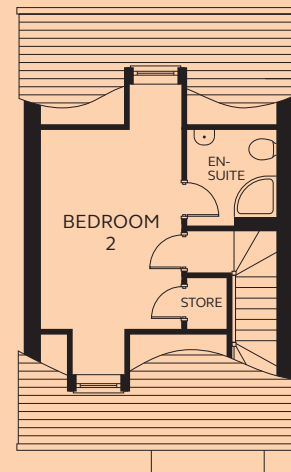

FIRST FLOOR

Devonshire Homes endeavours to provide accurate and reliable sales details in order to provide purchasers with a valid representation of the finished houses. However, during the process of construction, alterations may become necessary and various changes and improvements can occur. Dimensions should be used as a guide only and should not be used to order carpets or furniture and customers should satisfy themselves of the actual dimensions of the property they are purchasing. Elevations, materials, style and position of windows and porches can all differ in the same house type from plot to plot. Purchasers should ensure that they are aware of the detail and finish provided in a specific plot before committing to a purchase.