

Gwallon Keas
St Austell

HOLMBUSH
4



Gwallon Keas

St Austell



SINCE 1992

DEVONSHIRE HOMES

HOLMBUSH

4 FH

The Holmbush is a spacious four-bedroom family home. On the ground floor from the hallway enter the open plan kitchen / dining room / living room with French doors opening out into the rear garden.

The first floor has four bedrooms and a family bathroom and extra storage on the landing. The master bedroom includes fitted wardrobes.

GROUND FLOOR

Kitchen/Living/Dining 5.94 – 3.61m x 8.85 – 3.44m

Cloakroom 0.90m x 1.80m

FIRST FLOOR

Bedroom 1 3.75m x 3.04m (inc wardrobe space)

Bedroom 2 3.62m x 2.80m

Bedroom 3 2.58 – 3.00m x 2.82m

Bedroom 4 1.53 – 2.23m x 2.80 – 3.50m

Bathroom 2.10m x 1.90m

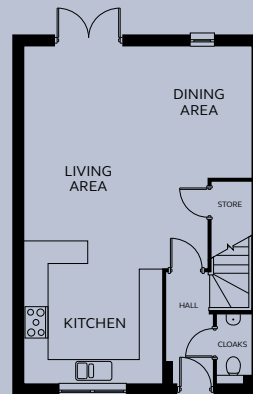

GROUND FLOOR

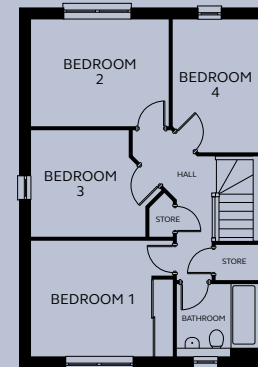

FIRST FLOOR

Devonshire Homes endeavours to provide accurate and reliable sales details in order to provide purchasers with a valid representation of the finished houses. However, during the process of construction, alterations may become necessary and various changes and improvements can occur. Dimensions should be used as a guide only and should not be used to order carpets or furniture and customers should satisfy themselves of the actual dimensions of the property they are purchasing. Elevations, materials, style and position of windows and porches can all differ in the same house type from plot to plot. Purchasers should ensure that they are aware of the detail and finish provided in a specific plot before committing to a purchase.

gwallonkeas@devonshirehomes.co.uk